



***PERSHING***

---

**PERSHING 70'**





**PERSHING**

**PERSHING 70'**





**PERSHING**

**PERSHING 70'**





**PERSHING**

PERSHING 70'





**PERSHING**

PERSHING 70'





**PERSHING**

**PERSHING 70'**





**PERSHING**

**PERSHING 70'**





**PERSHING**

**PERSHING 70'**





**PERSHING**

PERSHING 70'





**PERSHING**

**PERSHING 70'**





**PERSHING**

**PERSHING 70'**





**PERSHING**

**PERSHING 70'**





**PERSHING**

**PERSHING 70'**





**PERSHING**

**PERSHING 70'**





**PERSHING**

**PERSHING 70'**





**PERSHING**

**PERSHING 70'**





**PERSHING**

**PERSHING 70'**





**PERSHING**

**PERSHING 70'**





**PERSHING**

**PERSHING 70'**





**PERSHING**

**PERSHING 70'**













**PERSHING**

**PERSHING 70'**





**PERSHING**

PERSHING 70'



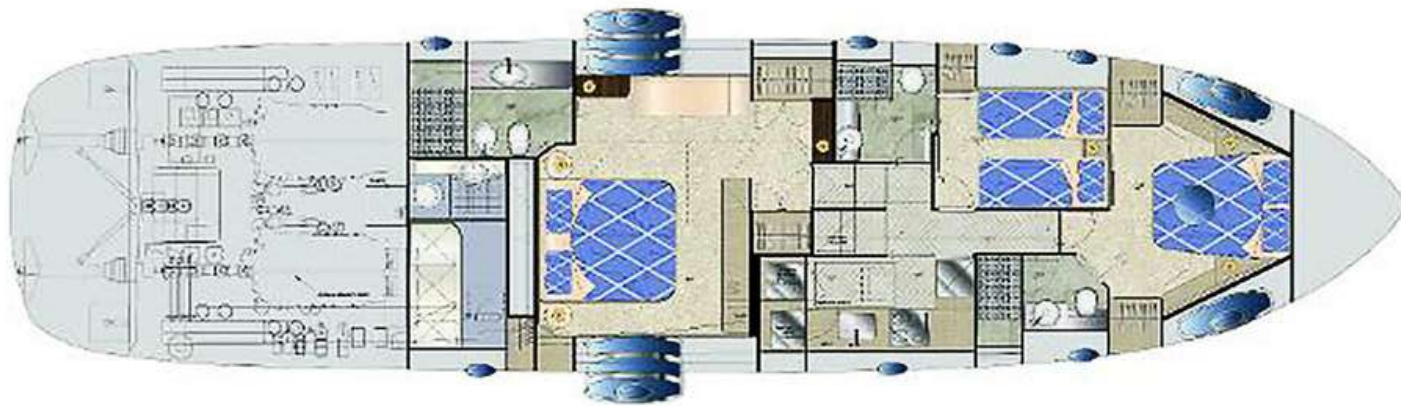
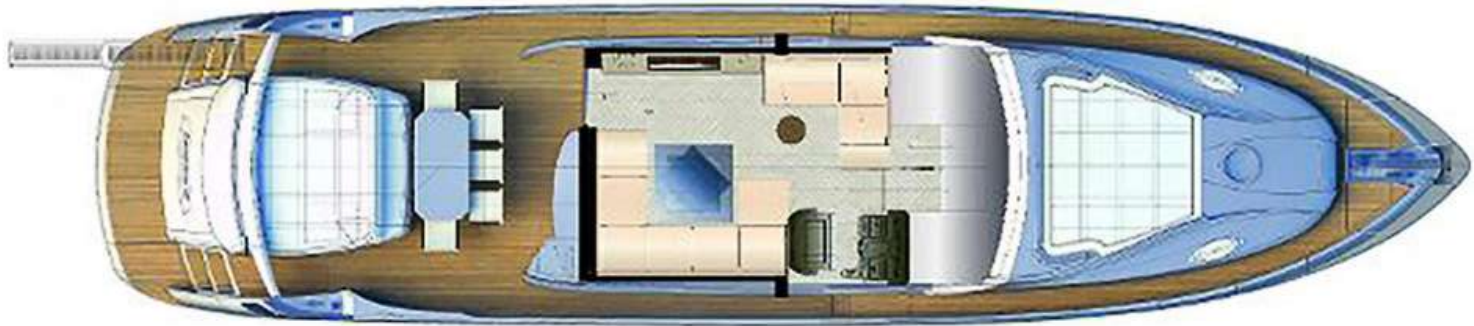



## PERSHING 70'

Pershing 70' is characterized by very dynamic lines and an innovative new design. It stands out for its futuristic and imposing forms, enhanced by a carefully selected colour palette and an unusual structural design. You can sit comfortably in the cockpit, enveloped by silence, while your Pershing 70 plows the waves at over 46 knots and the sea whisks by in the side windows. The merit of this phenomenal mixture of speed, comfort and performance, is down to the design that merges good looks and functions with the fundamental role of technology and the power of its engines.

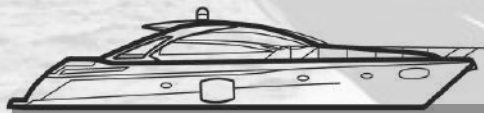



 **GENERAL SPECIFICATIONS**

- **Builder:** Pershing
- **Model:** 70'
- **LOA:** 21 meters ( 70 ft)
- **Engine:** 2 x 1650 HP MTU
- **Type:** motor yacht
- **Max speed:** 48 knots
- **Cruising speed:** 42 knots
- **Pax:** 12 guest + 2 crew
- **Base:** Genova

 **ACCOMODATIONS**

- **Tot. cabins:** 3 (+1 crew)
- **Tot. berths:** 6 (+2 crew)
  
- **Double:** 2
- **Twin:** 1 (+1 crew)
- **WC:** 3 (+1 crew)

 **CREW**

- **Captain**
- **Hostess**

 **EQUIPMENT/EXTRAS  
& COMFORTS****Outside**

- **Big sunshade**
- **Bow sundeck**
- **Stern sundeck**
- **Fridge**
- **Grill**
- **Bluetooth stereo**
- **Swimming ladder**
- **Sweat water shower**
- **Wooden finishes**
- **Teak deck**
- **Gangway**
- **Garage**
- **Jet tender**

**Inside**

- **Kitchen**
- **2 big tables**
- **2 big sofas**
- **Fridge**
- **Freezer**
- **Water maker**

- **Ice maker**
- **Tv**
- **Bluetooth stereo**
- **Air conditioning**
- **Hot water**
- **Coffee maker**
  
- **GYROSTABILIZER SEAKEEPER**